

Ref no.

BA/N/25/05/243

BAP/N/25/05/285

BA8/N/25/05/177

30/5/2025



To: All Residents of Bel-Air

致：貝沙灣各住戶

Latest Update on Temporary Traffic Arrangement at Sections of Carriageway along Victoria Road

域多利道部分行車路實施臨時交通最新安排

DETAILS 詳情:

Please be informed that the Temporary Traffic Arrangement ("TTA") on Victoria Road for the construction work for Public Housing Developments at Pok Fu Lam has been updated. Below are the key details:

Effective Dates and Traffic Changes

- 15 February 2025 – Mid-August 2025: A section of the carriageway along Victoria Road (near Pok Fu Lam Road) temporarily narrowed (Monday to Saturday 10:00am-3:00pm)
- From 27 April 2025: A section of Victoria Road traffic lane slightly moved toward the Wah Fu North Site Maintain → Two-way traffic
- From 2 May 2025 – 1 July 2025: A section of Victoria Road temporarily closed as stated below → One-way Southbound traffic
- **From 30 May 2025 – 15 June 2025: A section of the carriageway along Pok Fu Lam Road Southbound and Victoria Road (near Pok Fu Lam Fire Station) temporarily narrowed in stages (Tuesday to Friday, between 00:00 am and 05:00 am)**

Traffic Flow (Except Public Holidays)

Monday – Friday:	- 10:00am – 3:00pm: One-Way Southbound Traffic only & narrowed Victoria Road
Tuesday - Friday	- 12:00 am - 5:00 am : Narrowed Pok Fu Lam Road Southbound and Victoria Road
Saturday:	- 7:00am – 6:00pm: One-Way Southbound traffic only
	- 10:00am – 3:00pm: Narrowed Victoria Road

Please allow extra travel time during these periods to avoid delays. Should you have any enquiries regarding the TTA, you may contact 24-hour hotline at 5269 3039 or email: emily.chiu@cv202001.com.

位於薄扶林的公共房屋發展工程，在域多利道的臨時交通安排已更新。以下是主要細節：

生效日期及交通安排

- 2025 年 2 月 15 日至 8 月中旬：部分域多利道(近薄扶林道)行車路臨時收窄(星期一至六 早上 10 時至下午 3 時)
- 2025 年 4 月 27 起：域多利道的一段行車道稍微向華富北工地方向遷移，並保持雙程行車
- 2025 年 5 月 2 日至 7 月 1 日：域多利道的一段行車道於以下時段暫時封閉，實施南行單線行車
- **2025 年 5 月 30 日至 6 月 15 日：收窄薄扶林道南行及域多利道近薄扶林消防局部份行車路臨時收窄(星期二至五，凌晨 0 時至早上 5 時)**

交通安排如下：(公眾假期除外)

星期一至五:	- 早上 10 時 – 下午 3 時: 南行單線行車 及 收窄部分域多利道
星期二至五:	- 凌晨 0 時至早上 5 時: 收窄薄扶林道南行及域多利道
星期六:	- 早上 7 時 – 下午 6 時: 南行單線行車
	- 早上 10 時 – 下午 3 時: 收窄部分域多利道

請各住戶於上述時段預留更多的行車時間，以避免延誤。如對臨時交通安排有任何疑問，請致電 24 小時熱線 5269 3039 或電郵至：emily.chiu@cv202001.com。

張貼至
Post Until

1/7/2025

此通告已上載於貝沙灣網頁 www.bel-air-hk.com，如有查詢，歡迎致電 2989 6000 (一至三期) 或 2989 6350 (四至六期)與貝沙灣服務中心聯絡。

This notice has uploaded to Bel-Air web-site www.bel-air-hk.com. Should you have any enquiries, please feel free to contact Residence Bel-Air Service Centre at 2989 6000 on 2989 6000 (Phase 1-3) or 2989-6350 (Phase 4-6)

Island South Property Management Limited 南盈物業管理有限公司 (PMC License Number 物業管理公司牌照號碼：C-191466)



貝沙灣

土木工程拓展署合約編號: CV/2020/01

薄扶林南公營房屋發展之工地平整及基礎設施工程

CEDD Contract No. CV/2020/01

Site Formation and Infrastructure Works for Public Housing Developments at Pok Fu Lam South

2025年5月21日

通告

薄扶林道(南行)及域多利道(近薄扶林消防局)部份行車路實施臨時交通安排 (晚間工程)

為配合土木工程拓展署合約編號:CV/2020/01的工程需要，承建商將會分階段臨時收窄薄扶林道(南行)及域多利道(近薄扶林消防局)部份行車路及實施臨時交通安排(見附件一及二)，以進行拆除安全圍欄工程及運送工程物料。此臨時交通安排將於2025年5月下旬開始分階段實施(星期二至五，公眾假期除外，凌晨0時至早上5時)，為期約2星期。

階段一：臨時收窄薄扶林道(南行)部分行車路(約240米長)(見附件一，綠色範圍)，以進行拆除安全圍欄工程及運送工程物料；及

階段二：臨時收窄薄扶林道(南行)及域多利道(近薄扶林消防局)部分行車路(分別約170米長及約120米長)(見附件二，綠色範圍)，以進行拆除安全圍欄工程及運送工程物料。

臨時交通安排實施期間，有關位置範圍將會設有防護欄分隔工地範圍及相關告示牌指示車輛行駛。

因工程引起不便之處，敬請見諒。如有查詢，請致電工程熱線 5269-3039、或者透過 WhatsApp: 5269-3039、或電郵至：emily.chiu@cv202001.com 與我們聯絡。

NOTICE

Temporary Traffic Arrangement at Sections of Carriageway along Pok Fu Lam Road Southbound and Victoria Road (near Pok Fu Lam Fire Station) **(Night Works)**

To cope with the construction work of CEDD Contract No. CV/2020/01, some sections of the carriageway along Pok Fu Lam Road Southbound and Victoria Road (near Pok Fu Lam Fire Station) will be temporarily narrowed in stages (**as illustrated in Annex A & B**) to facilitate safety fence removal works and loading and unloading of construction materials. The temporary traffic arrangement (TTA) will be implemented in stages from **late May 2025 (Tuesday to Friday, except public holidays, between 00:00 am and 05:00 am) for approximately 2 weeks.**

Stage 1 : A section of the carriageway (approx.240m long) along Pok Fu Lam Road Southbound will be temporarily narrowed (**as marked in green on Annex A**) to facilitate safety fence removal works and loading and unloading of construction materials; and

Stage 2 : A section of the carriageway (approx.170m long and approx.120m long) along Pok Fu Lam Road Southbound and Victoria Road (near Pok Fu Lam Fire Station) will be temporarily narrowed (**as marked in green on Annex B**) to facilitate safety fence removal works and loading and unloading of construction materials.

During the implementation of the TTA, the works area will be fenced off and appropriate traffic signs will be erected to guide road users.

We apologize for any inconvenience caused. Should you have any enquiry, please do not hesitate to contact us at our Project Hotline: 5269-3039, or through WhatsApp at 5269-3039, or email: emily.chiu@cv202001.com.

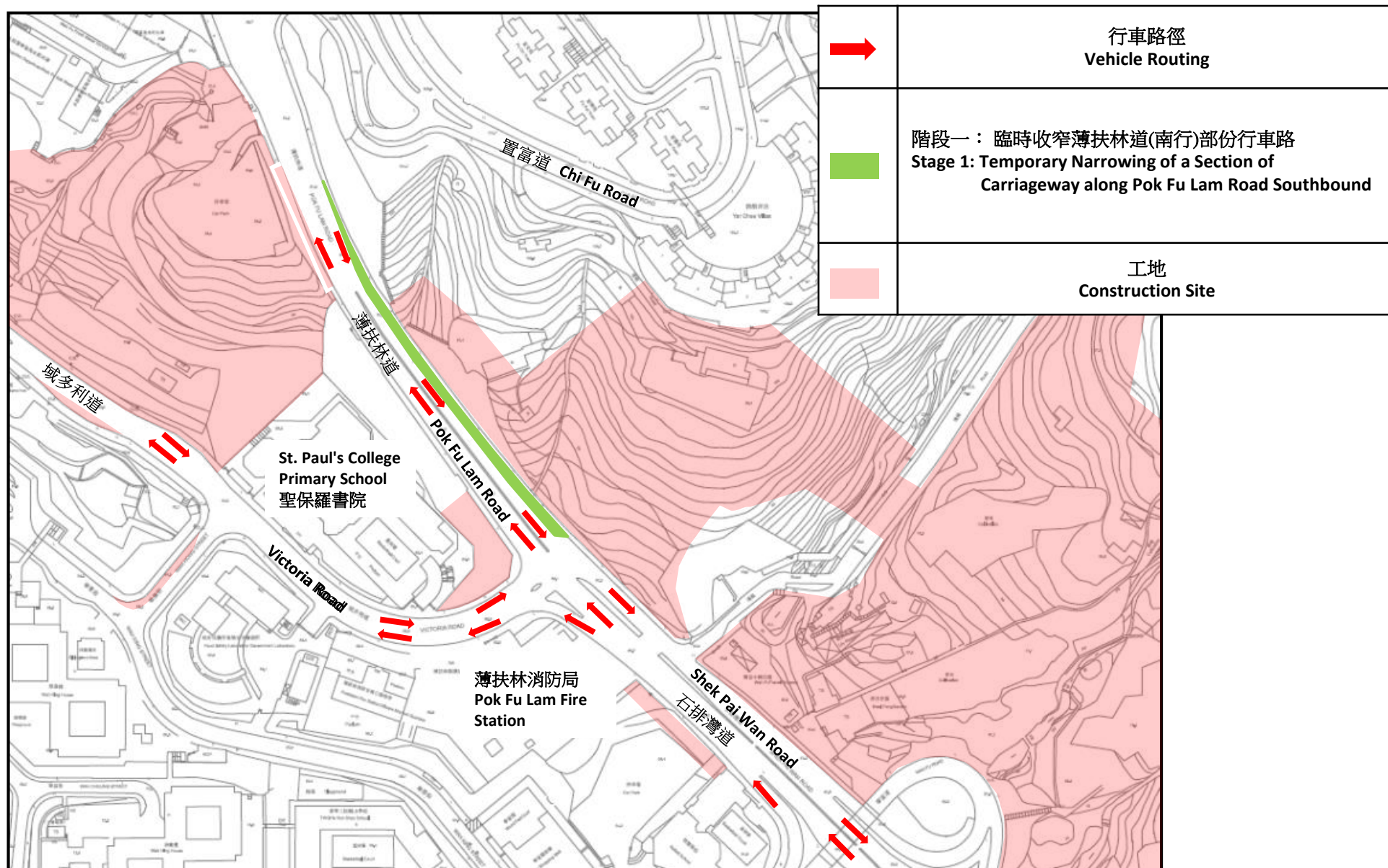

Site Formation and Infrastructure Works for Public Housing Developments at Pok Fu Lam South
附件二 (Annex B)

